



0207 491 0207

**JONES
NORRIS
ADAMS**

CHARTERED SURVEYORS

15a Berghem Mews 158a Blythe Road W14 0HN

Offices 1,065 ft² (m²) approx.



LOCATION

These most attractive media-style Mews offices are arranged around a paved courtyard in the heart of fashionable Brook Green. Sandwich bars, gastro pubs and Brook Green Tesco superstore are within easy walking distance. Shepherds Bush (Westfield) **Central Line** and Hammersmith (**Piccadilly Line**) tubes are within 10 minutes walk.

DESCRIPTION

A bright first floor office suite with its own kitchen area and two partitioned offices and a storage room. There is cycle parking and an on site shower.

Floor	Sq. Ft	Sq. M
1st	1,065	99

AMENITIES

- Tea point
- One parking space
- 24/7 access
- Good natural light
- On site security
- Shared on site shower
- Cycle racks

LEASE

A new lease for a term of 3 to 5 years to be agreed

RENT

£36.50 psf

BUSINESS RATES

£9.50 psf approx. subject to verification 2017/18

SERVICE CHARGE

£7.50 psf approx.

EPC

Rating B

Cont'/.....

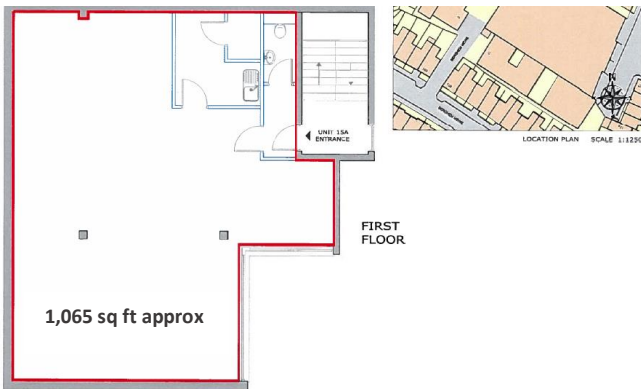

For more information or to arrange a viewing, please contact:

Georgia Eckert

georgia.eckert@jnaproperty.com

020 7491 0207

07947 63 8446

Neville Forrest

Neville.forrest@jnaproperty.com

0207 491 0207

07770 477 166

Mark Belsham

At joint agents HNG

0203 205 0200

07973 372 698

Mark.belsham@hng.co.uk

